

D'Centers

DIABETES RESOURCE CENTRE

An activity by

NADI NATIONAL
DIABETES
INSTITUTE
CENTRE OF EXCELLENCE-DEDICATED TO DIABETICS

Endorsed by



Now open at

*Botanic Business
Gateway*

OPERATING HOURS
Monday to Friday
9.00am - 5.00pm
Lunch Hour
1.00pm - 2.00pm

CURRENT SERVICES/FACILITIES

**SUBSIDISED
CHARGES**

1. CONSULTATIONS

- ✓ **Diabetes Advice by Diabetes Educator** to help you better manage your diabetes

2. TESTS

- ✓ **Blood Sugar Test** to screen if you have diabetes
- ✓ **HbA1c** to assess how good your diabetes control is
- ✓ **OGTT** to check if you have diabetes or prone to having diabetes (IGT)
- ✓ **Microalbuminuria Test** to check if you have kidney complication
- ✓ **Lipid (Blood Fat) Test** to check your cholesterol level and risk to heart disease
- ✓ **ECG** to check your heart function

3. TREATMENTS

- ✓ **Anodyne Therapy** to help treat nerve damage in the feet (common complication of diabetes)
- ✓ **Zazen Far Infrared Sauna** assists in reducing body weight, increase insulin sensitivity for better diabetes control

4. PRODUCTS FOR SALE AT AFFORDABLE PRICE

- Blood glucose monitoring kits
- Medical nutrition products
- Insulin pen needles
- Special diabetes foot wear

UPCOMING SERVICES/FACILITIES

- ✓ **Specialist/Diabetologist consultation** on diabetes, heart disease and related conditions
- ✓ **Diet advice** by dietitian
- ✓ **Pharmacy service (NADI Pharma)** for supply of drugs at reduced cost
- ✓ **Eye Assessment** with fundus camera
- ✓ **Foot care: Assessment and Treatment**
- ✓ **Medication advice** by pharmacist
- ✓ **Displays** of diabetes and cardiovascular (eg. heart disease, high blood pressure) drugs
- ✓ **Self-learning facility** (pamphlets, booklets, internet) on diabetes & heart diseases
- ✓ **Group counselling session** on diabetes & heart disease

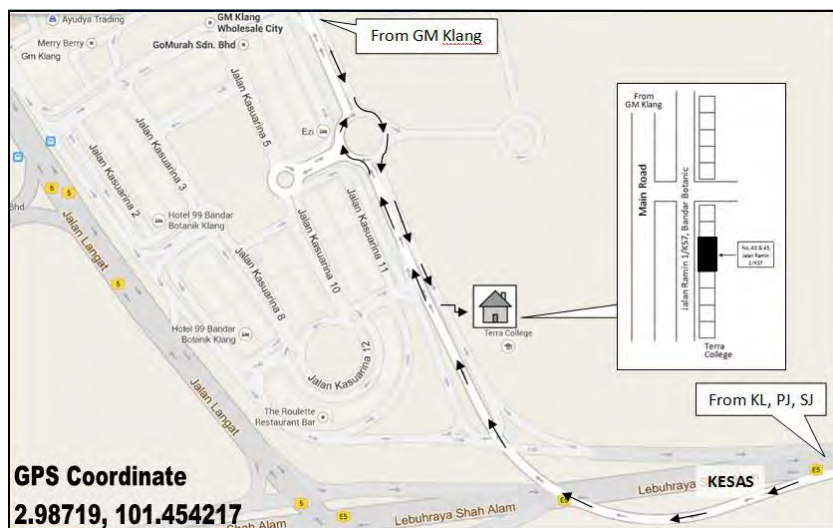

**No. 43 & 45, Jalan Ramin 1/KS7, Bandar Botanic
41200 Klang Selangor**

For enquiries and appointment please contact

Tel: 03-3319 4100/4200/4300

Email: enquiry@nadidiabetes.com.my